

Data Sheet

Type Number 386
Designation IEC SR 43
System Silver oxide / Zinc /
 KOH - Electrolyte

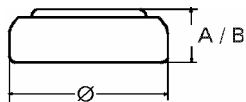

Nominal Voltage 1,55 V
Typical Capacity C 105 mAh
 Load 5.6 kOhm, at 20°C down to 1.3 V

Weight (approx.) 1,78 g
Volume 0,39 ccm

Temperature Ranges

	min	max.
Storage	-10°C	65 °C
Discharge	-10°C	65°C

Dimensions

	min	max.
Diameter (A)	11,25	11,6
Height (B)	3,8	4,2

Segment Watch / High Drain

Main Applications Watch
 Photo
 Electronic

Typical Capacities (at 20°C)

Discharge Type	Load	End Voltage: 1.3 V
Continuous 24h/d,7d/w Current [µA]:	5600 Ω 275	Time: 380 h Capacity [mAh]: 105 Energy [MWh]: 162